



7469-11  
 30-78  
 -7469-1

3635

LEGAL DESCRIPTION AND LOCATION: S 1/2 SE 1/4  
20 AC.  
Buffalo River  
 Lake No. 9 Lake Name 140 Lake Classif. 43 Sec. 9 TWP 140 Range 43 TWP Name CUBA

600ft + 1600ft along Road  
 07.0041.000  
 Septic 1978

IDENTIFICATION: Please Print All Information

Last Name	First	Initial	Mailing Address— No. Street, City and State	Zip No.	Tel. No.
Owner	DITTERICK, NORBERT		PO. Box 195 Lake Park, Minn.	56554	
Contractor	Name		Juan Kaiser		

TYPE OF IMPROVEMENT:  New Building ( ) Alteration ( ) Other

RESIDENTIAL PROPOSED USE:  One Family Dwelling ( ) Multiple Dwelling Units

NON-RESIDENTIAL PROPOSED USE: Specify: House at Garage 24x30'  
 Size: 26'x48'

ESTIMATED COST OF IMPROVEMENT \$ 40,000 Construction Starting Date:

PRINCIPAL TYPE OF FRAME:  Masonry  Wood Frame ( ) Structural Steel ( ) Other - Specify

Type of Roof: Asphalt

TYPE OF SEWAGE DISPOSAL: ( ) Public  Individual Septic Tank, etc.

WATER SUPPLY: ( ) Public  Individual Well

MECHANICAL EQUIPMENT: Elevator: ( ) Yes  No  
 Air Conditioning: ( ) Yes  No ( ) Central ( ) Unit

DIMENSIONS: Basement:  Yes ( ) No  
 Stories above basement: \_\_\_\_\_  
 Sq. feet (outside dimension) 1248 sq ft  
 Bedrooms 3 Baths 1 1/2

HEATING:  Electric ( ) Gas ( ) Oil ( ) Coal ( ) None  
 Other: wood 12'x65'

SEWAGE DISPOSAL SYSTEM DATA:	SEPTIC TANK	SEEPAGE <sup>FT</sup>	DRAIN FIELD
Capacity	1000 Gls.	375 Sq. Ft.	Sq. Ft.
Distance from nearest well	50 Ft.	50 Ft.	Ft.
Distance from lake or stream	75 Ft.	75 Ft.	Ft.
Distance from occupied building	10 Ft.	10 Ft.	Ft.
Distance from property line	10 Ft.	10 Ft.	Ft.
Distance from bottom to Water Table	Ft.	4 Ft.	Ft.

All distances are shortest distance between nearest points

CHARACTERISTICS:

Lot Area is 22 AC square feet. Water frontage is 1600 feet.  
 Building set back from high water mark is 300 feet. (Building Line)  
 Land height above high water mark at building line is 3.0 feet  
 Building set back from State highway is \_\_\_\_\_ feet - from road or street is TWP 200 feet.  
 Side yard is 400 and 20 feet. Rear yard is 45 feet.  
 Building will be located over 10 feet from septic tank (Sewage System Permit must be obtained before installation).  
 Building will be located over 10 feet from soil absorption system (Cesspool, Drainfield, etc.).

Agreement: I hereby certify that the information contained herein is correct and agree to do the proposed work in accordance with the description above set forth and according to the provisions of the ordinances of Becker County, Minnesota. I further agree that any plans and specifications submitted herewith shall become a part of this permit application. I also understand that this permit is valid for a period of six (6) months. Applicant further agrees that no part of the sewage system shall be covered until it has been inspected and accepted. It shall be the responsibility of the applicant for the permit to notify the County Zoning Administrator, 48 hours before the job is ready for inspection.

Dated 1-30-78  
 Signature of Owner: Norbert Ditterick

Permit: Permission is hereby granted to the above named applicant to perform the work described in the above statement. This permit is granted upon the express condition that the person to whom it is granted, and his agent, employees and workmen shall conform in all respects to the ordinances of Becker County, Minnesota. This permit may be revoked at any time upon violation of said ordinances.

Dated 1-31-78  
 Permit Fee \$ 45.00 State Surcharge \$ .50  
 Signature of Becker County Zoning Administrator: Floyd Lundy

Comments: pl 1-30-78 - kid by mail.

Scale: Each grid equals \_\_\_\_\_ feet/inches.

**GRID PLOT PLAN SKETCHING FORM**

Application for Building Permit Dated \_\_\_\_\_ 19 \_\_\_\_\_

07.0041.000

Septic 1978

Application for Sewage System Permit Dated \_\_\_\_\_ 19 \_\_\_\_\_

Building Permit Number \_\_\_\_\_ Sewage System Permit Number \_\_\_\_\_

Applicant agrees that this plot plan is a part of application (s) indicated above.

Dated \_\_\_\_\_ 19 \_\_\_\_\_

Signature \_\_\_\_\_

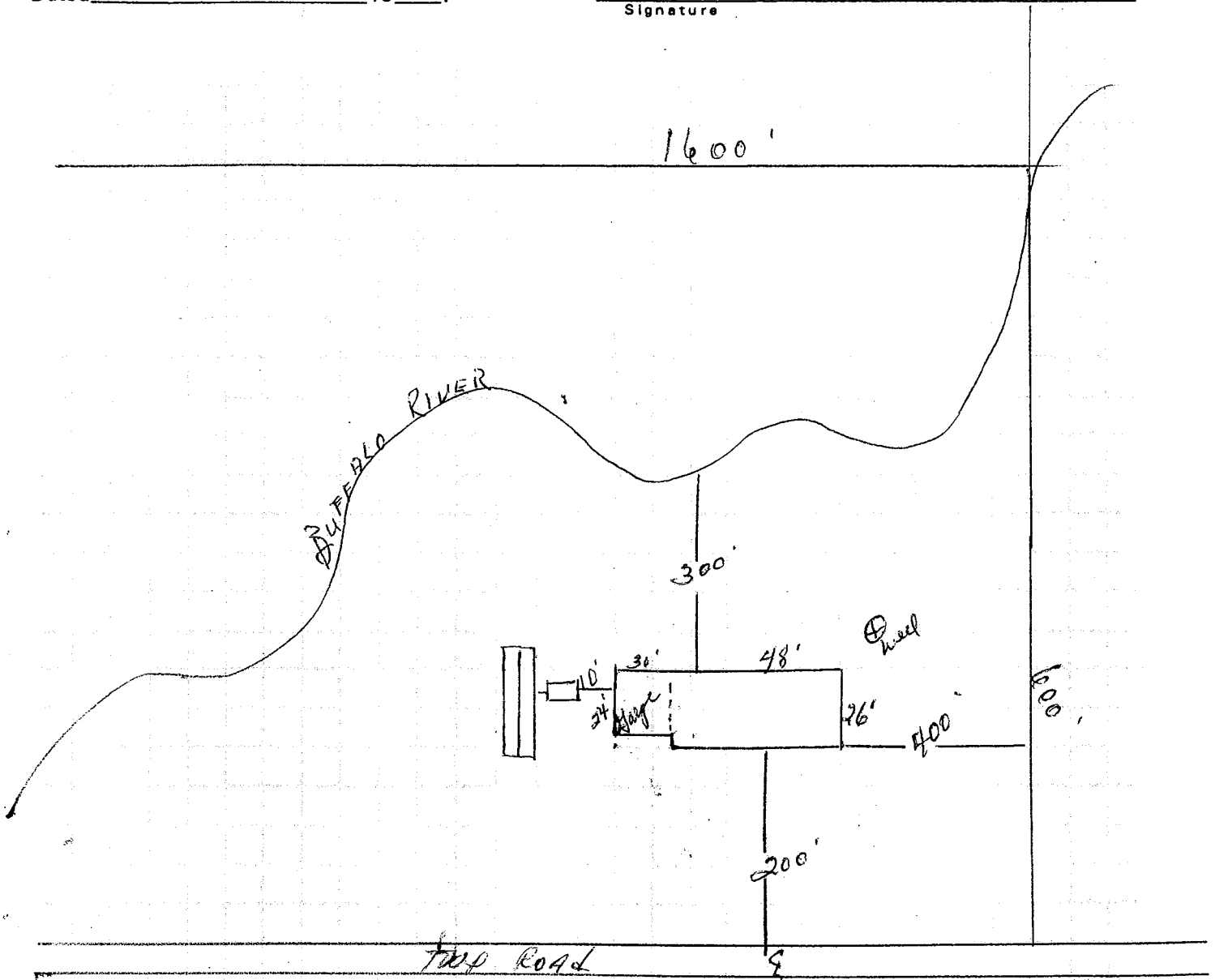

- W — File
- Y — Owner
- B — Building Inspector

07.0041.000  
Septic 1978

# BECKER COUNTY

## Sewage Permit No. SP No. \_\_\_\_\_

**Location:** Lake No. \_\_\_\_\_ Sec. \_\_\_\_\_ Twp. \_\_\_\_\_ Range \_\_\_\_\_ Twp. Name \_\_\_\_\_

**Issued** \_\_\_\_\_ **19** \_\_\_\_\_, **To** \_\_\_\_\_

### Work Authorized

1000 gal. septic tank, over 50 ft. from nearest well, over 75 ft. from sewer, over 10 ft. from occupied building, over 10 ft. from property line, seepage bed will be 375 sq. ft., (12x65), over 50 ft. from nearest well, over 75 ft. from sewer, over 10 ft. from occupied building, over 10 ft. from property line, and over 4 ft. from building to water table. lot area is 22 acres, water frontage is \_\_\_\_\_

**NOTE:** This card must be placed in a conspicuous place not more than 12 feet above grade on the premises on which work is to be done, and must be maintained there until completion of such work. No part of system shall be covered until it has been inspected and approved. Notify Zoning Administrator, (847-3938) office when job is ready for inspection.

*Alfred Shively*

Becker County Zoning Administrator

BECKER COUNTY, MINNESOTA  
Board of County Commissioners